

Company Name: _____

Phone#: _____

Contact Name: _____

Fax#: _____

E-mail Address: _____

P.O.#: _____

Method of Shipment: (please mark one)

UPS Next Day Air

UPS 2nd Day Air

UPS 3-Day

UPS Ground

FineLine 100PC Torch Consumable Parts Ordering Form

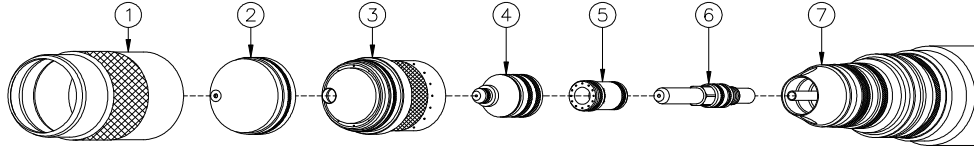

<u>Item #</u>	<u>Part #</u>	<u>Description</u>	<u>Quantity</u>
1	500009	Outer Retaining Cap-all amperages	_____
2	501213	Shield Cap-15/30 Amp Mild Steel/Aluminum 70 Amp Stainless Steel Plasma Marking	_____
2	501214	Shield Cap-50/70 Amp Mild Steel/Aluminum	_____
2	501215	Shield Cap-100 Amp Mild Steel 100 Amp Stainless Steel 100 Amp Aluminum	_____
2	501216	Shield Cap-30 Amp Stainless Steel	_____
2	501217	Shield Cap-50 Amp Stainless Steel	_____
3	501210	Inner Retaining Cap-15/30/50/70 Amp Mild Steel 15/30/50 Amp Aluminum	_____
3	501211	Inner Retaining Cap-100 Amp Mild Steel 70/100 Amp Stainless Steel 70/100 Amp Aluminum Plasma Marking	_____
3	501212	Inner Retaining Cap-30/50 Amp Stainless Steel	_____
4	500301	Nozzle-15 Amp Mild Steel 15 Amp Aluminum	_____
4	500311	Nozzle-30 Amp Mild Steel 30 Amp Aluminum Plasma Marking	_____
4	500315	Nozzle-30 Amp Stainless Steel	_____
4	500321	Nozzle-50 Amp Mild Steel 50 Amp Aluminum	_____
4	500325	Nozzle-50 Amp Stainless Steel	_____
4	500331	Nozzle-70 Amp Mild Steel	_____

FineLine 100PC Consumable Order Form (continued)

4	500601	Nozzle-70 Amp Stainless Steel 70 Amp Aluminum	_____
4	500341	Nozzle-100 Amp Mild Steel	_____
4	500661	Nozzle-100 Amp Stainless Steel 100 Amp Aluminum	_____
5	500230	Swirl Ring-all amperages except 30 Amp Stainless Steel	_____
5	500225	Swirl Ring-30 Amp Stainless Steel	_____
6	500101	Endura™ Electrode-15/30 Amp Mild Steel 15/30 Amp Aluminum	_____
6	500102	Endura™ Electrode-30/50 Amp Stainless Steel	_____
6	500131	Endura™ Electrode-50/70 Amp Mild Steel 50/70 Amp Aluminum 70 Amp Stainless Steel	_____
6	500141	Endura™ Electrode-100 Amp Mild Steel 100 Amp Stainless Steel 100 Amp Aluminum	_____
6	500281	Endura™ Electrode – Plasma Marking	_____
7	500715	Torch Main Body- with torch exchange without torch exchange	_____ _____
not shown	500018	Torch O-Ring (red, upper – seals inner retaining cap)	_____
not shown	500024	Torch O-Ring (blue, lower – seals inner retaining cap)	_____
not shown	820209	Torch O-Ring (black – seals outer retaining cap)	_____
not shown	716012	O-Ring Lubricant - Oxygen Compatible	_____
not shown	500695	FineLine Coolant – 1 gallon	_____
not shown	500591	Consumable Removable Tool	_____



FAX# 843-795-8931

January 2005